

PRORIL

50 Hz

Designed for light weight, excellent performance, low energy consumption, and easy maintenance, PRORIL residue pumps can pump down to a low water level at 1/16" (2mm), which is ideal for pumping flat surface such as basements, parking garages, pools, spas and etc.



Handy and Residue Pump

SMART LITE BASE 400

Residue Pump

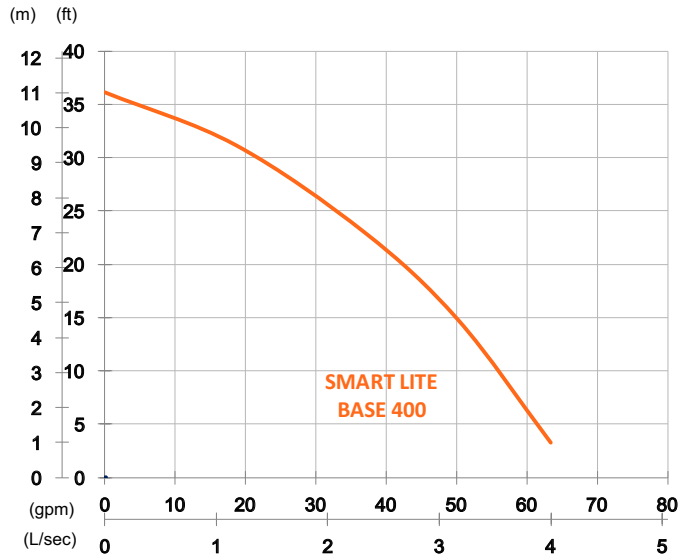

Shaft Speed : 2850 rpm

Outlet : 50mm, 2in

| OUTPUT | HEAD | FLOW |
|--------|------------------|-------------------------|
| 0.4 kW | Rated : 7m, 23ft | Rated : 2.3 L/s, 37 gpm |
| 0.5 HP | Max : 11m, 36ft | Max : 4 L/s, 63 gpm |

Solid Passage : 2 mm, 0.1 in

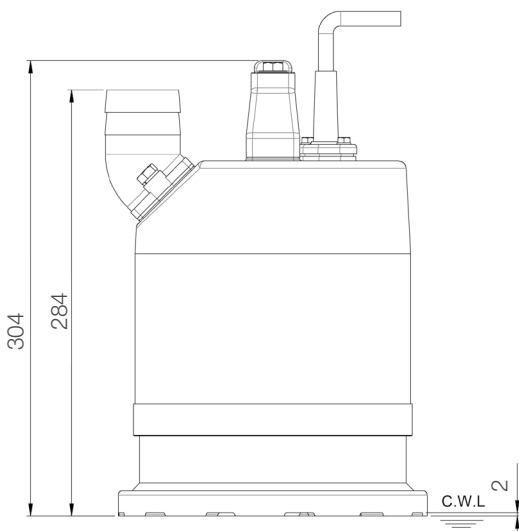
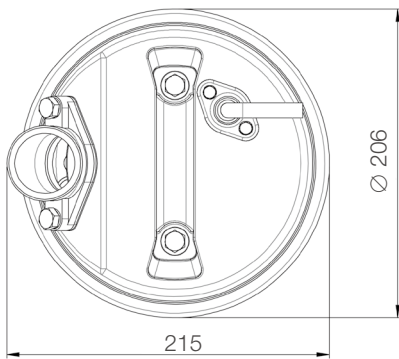

unit : mm

Weight : 11kg / 24 lbs

| | | |
|-------------------------|----------------|-------------------------------------|
| Pump Type | | Electric Submersible Pumps |
| | | 1-Phase |
| Motor | Type | Induction Motor |
| | Poles | 2 Pole |
| | Insulation | Class F |
| | Protector | Miniature Thermal Protector |
| | Starter Method | Capacitor-Run |
| Lubricant | | Food Grade (ISO VG32) |
| Impeller Type | | Semi-Vortex |
| Shaft Seal | | Double Mechanical Seal |
| | | Silicon Carbide VS Ceramic / Carbon |
| Bearings | | C3 Shielded ball bearings |
| Cable | | PVC (CSA Certified) / H07RN-F |
| | | 6m (20ft) or longer upon request. |
| Materials | Pump Casing | Gray Iron |
| | Impeller | Synthetic Polymers |
| | Motor Frame | Aluminum |
| | Motor Shaft | Stainless Steel |
| | Outer Case | Aluminum |
| | Bottom Plate | Synthetic Rubber |
| Max. Liquid Temperature | | 40°C (104°F) |
| Max. Submersion Depth | | 20m (66ft) |
| pH Range | | pH 5 - pH 8 |